

331 Multisensor for RoomSet

The 331 Multisensor for RoomSet is the heart of Helvar RoomSet single-room lighting solution for commissioning classrooms, offices and meeting rooms. For the installer, the automatic preset programming allows for swift out-of-the-box installation, with no configuration needed.

RoomSet supports advanced graphical configuration via an easy-to-use Android app that enables a quick and simple setup for different purposes, such as presentations, lectures or conferences, or for daylight-harvesting. For commissioning large numbers of rooms, the RoomSet app allows copying room layouts, thus making the commissioning process faster and consequently more cost-effective.

The Multisensor for RoomSet has a light sensor for constant-light control, and a passive infrared (PIR) presence detector to provide energy-saving functions in a DALI system. It also hosts a microcontroller running RoomSet firmware with Bluetooth® low-energy connectivity to allow tablet-based configuration.

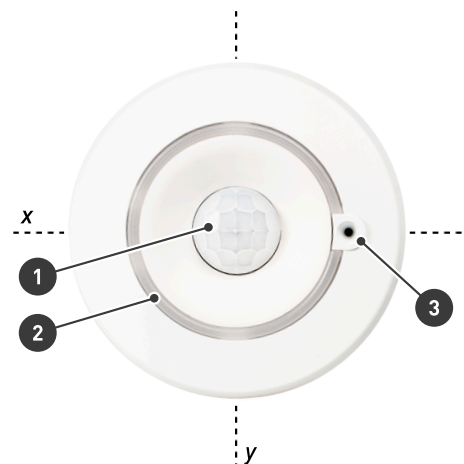

1. PIR sensor
2. Status/Indicator ring
3. Light sensor

Key Features

- Excellent detection performance through high sensitivity and multidirectional coverage
- Automated addressing and defaults programming to allow installer testing
- Functional system just by powering on the sensor
- Drag-and-drop graphical configuration of rooms with an intuitive Android app
- Over-the-Air upgrades via the RoomSet app to keep the system up to date with the latest available functionality
- Programmable constant-light control for energy efficiency
- Cost-effective deployment of large numbers of rooms

Constant Light Coverage

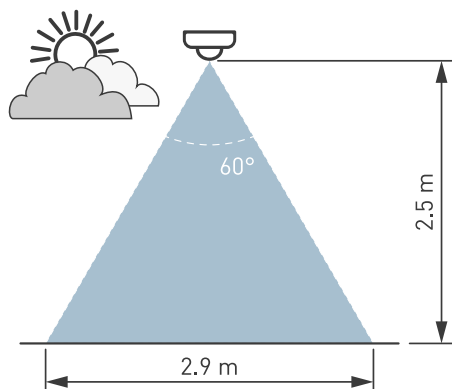

Detection

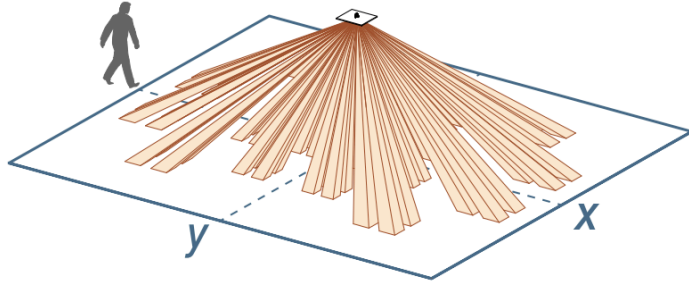

Detection pattern

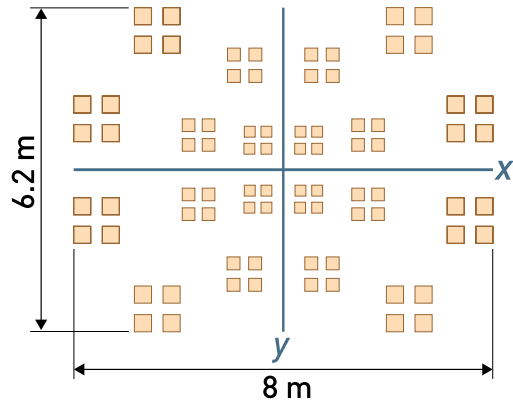

Detection Pattern at floor level for 2.5 m mounting height

Y-axis coverage

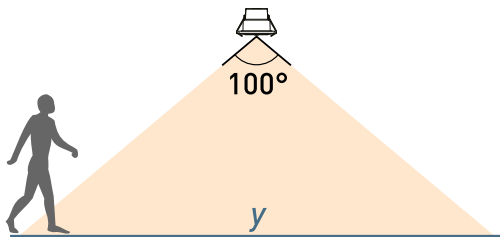

X-axis coverage

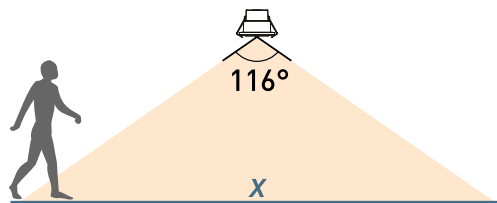

Connections

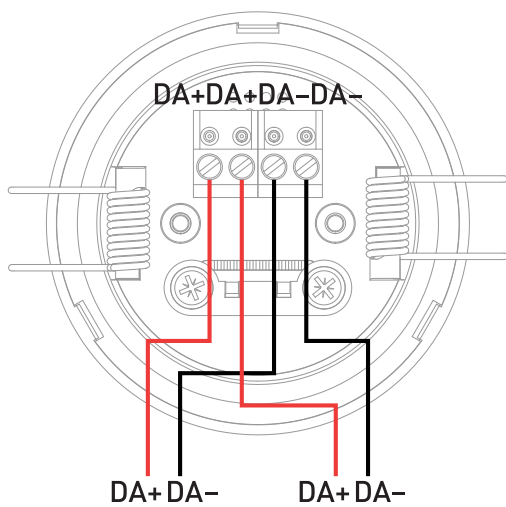

Dimensions (mm)

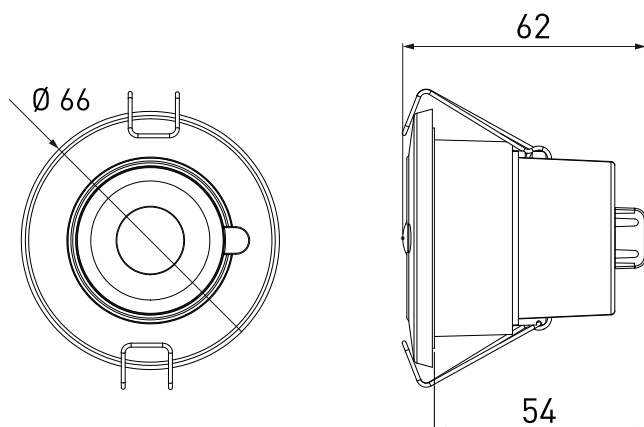

Technical Data

Connections

DALI:	Removable connector block Wire section: 0.5–1.5 mm ² , solid or stranded.
Cable rating:	All cables must be mains rated.

Electrical Data

DALI supply input:	9.5–22.5 V
DALI consumption:	40 mA Max

Sensors

Light sensor:	For constant-light functions
Presence detector:	Passive infrared (PIR)

Wireless connectivity

Frequency:	2.4 GHz
Technology:	Bluetooth® Low Energy

Mechanical data

Recommended mounting height:	Max. 4 m
Presence detection coverage area:	46 m ² @ 2.5 m mounting height
Mounting hole diameter:	51 mm +/- 1 mm
Note: If replacing an older sensor, 52–55 mm mounting hole is acceptable.	
Ceiling thickness:	Maximum 25 mm
Bezel diameter:	66 mm
Recommended clearance depth:	10 cm (with cable cover, including 5 cm for cabling)
Dimensions:	66 x 62 mm
Material (casing):	Nonflammable PC/ABS (UL94–V0)
Finish/Colour:	331: Semi-matt / White (RAL 9003) 331B: Semi-matt / Anthracite grey (RAL 7016)
Weight:	56 g
IP rating:	IP30 [IP20 cable cover]



Operating and storage conditions

Ambient temperature:	0 °C to +50 °C
Relative humidity:	Max. 90 %, noncondensing
Storage temperature:	-10 °C to +70 °C

Compatibility

Device:	Tablet (9.7" screen or larger recommended)
Software:	Android 6.0.2 or later BLE 4.1 or later

Conformity and standards

Conformity:	 
EMC emission:	EN 61000-6-3
EMC immunity:	EN 61547
RED:	EN 300 328, EN 301 489-1, EN 301 489-17
DALI:	IEC 62386
Safety:	EN 61347-2-11
Environment:	Complies with WEEE, RoHS and REACH directives.