

ActiveAhead Sense (5630)

The ActiveAhead Sense is a small luminaire-based sensor that combines a light sensor for constant light control and a passive infrared movement detector.

This sensor can be used on the self-learning smart wireless lighting control solution Helvar ActiveAhead.

If the sensor is connected to non-SELV control gear, the luminaire must be Class I.

Key Features

- Small and inconspicuous, it does not change the appearance of the luminaire.
- Provided with mounting features that can be snapped into sheet metal: two on each long side, and two on the rear.
- Part of the ActiveAhead self-learning wireless lighting control solution.

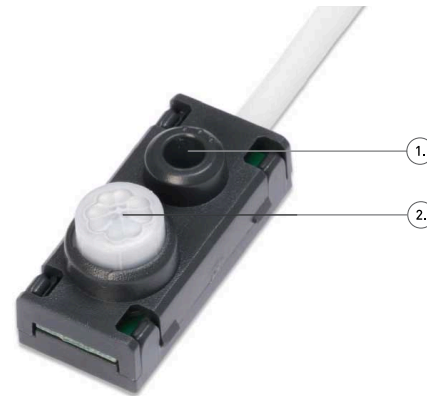

1. Light sensor
2. PIR sensor

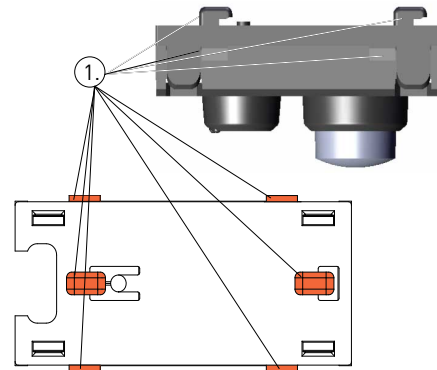

1. Mounting features

Light Sensor - For Constant Light Functions

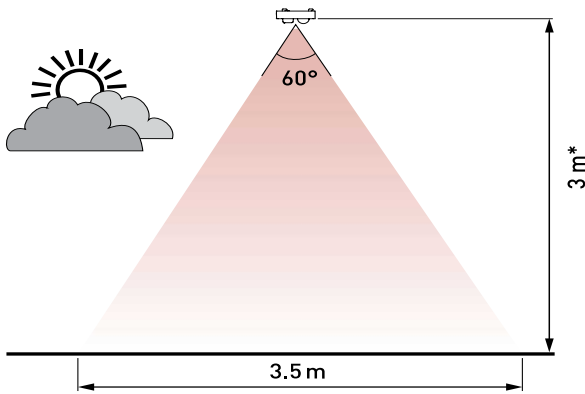

* Max recommended height 3 m

Presence Detector - Passive Infrared (PIR)

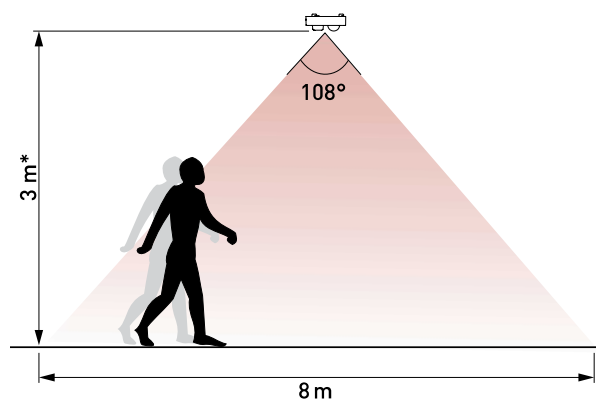

* Max recommended height 4 m

Detection Pattern for 2.5 m Mounting Height

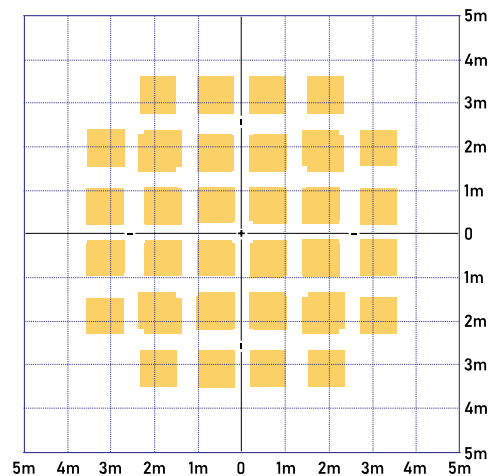

Connections

There are two set up scenarios:

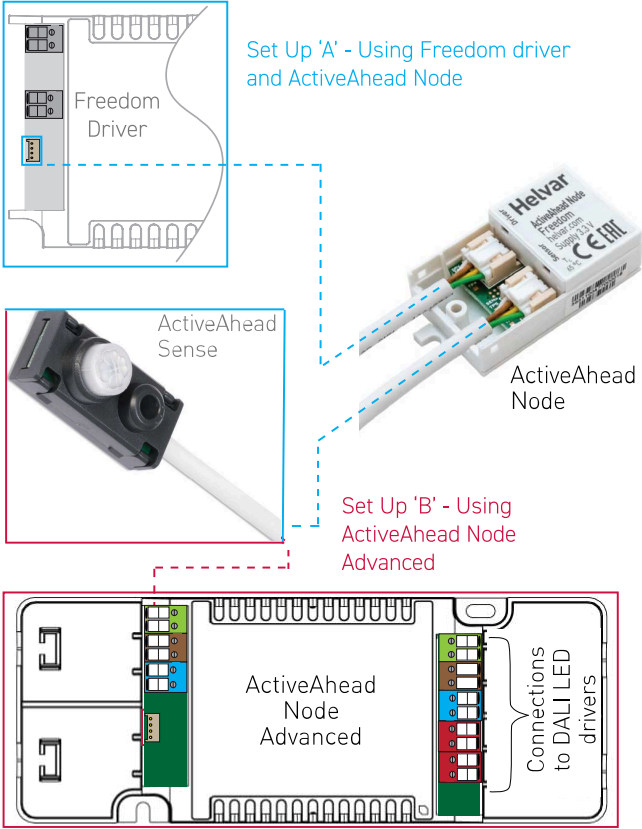

Connector side/rear view

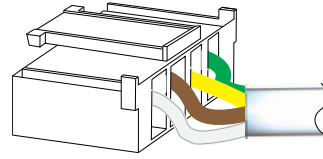

Note: Ensure each connector securely 'clicks' into place when plugged in correctly.

Mounting

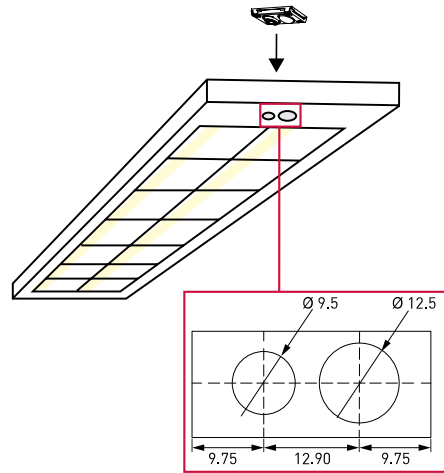

Dimensions (mm)

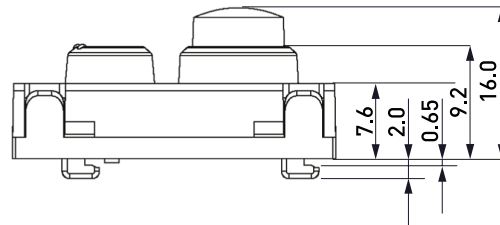
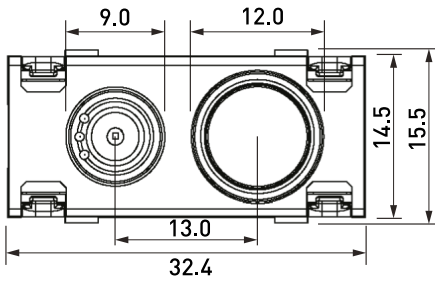

Note: Sensor holders are available to be used with the ActiveAhead Sense:

- 5691 - ActiveAhead Sense Rectangular Sensor holder
- 5692 - ActiveAhead Sense Circular Sensor holder

Technical Data

Connections	
ActiveAhead:	Flexible cable terminated with a four-way, 2 mm locking connector  Note: If the sensor is connected to non-SELV control gear, the luminaire must be Class I.

Conformity and standards	
Conformity:	
EMC emission:	EN 55015
EMC immunity:	EN 61547
Safety:	EN 61347-2-11
Environment:	Complies with RoHS directive.

Cable Information	
Order Code: 5630-30	Length: 30 cm, Colour: White
Order Code: 5630	Length: 80 cm, Colour: White
Order Code: 5630B	Length: 80 cm, Colour: Black
Order Code: 5630-150	Length: 150 cm, Colour: White

Mechanical data	
Dimensions:	32.4 mm × 15.5 mm × 18 mm
Material (casing):	Fire-retardant PC/ABS blend.
Colour:	White (RAL 9003) Black (RAL 7016)
IP code:	IP30
Weight:	22 g

Operating conditions	
Ambient temperature:	-20 °C to +50 °C  Note: The temperature difference between the detection target and the background must be at least 4 °C.
Relative humidity:	Max. 85 %, noncondensing
Storage temperature:	-20 °C to +70 °C
Illuminance:	5 lx to 5000 lx