

5636 Multisense R60 High Bay

The 5636 Multisense R60 High Bay is a luminaire-based sensor which can be used with wireless control solution Helvar ActiveAhead®. 5636 Multisense High Bay combines a PIR sensor for movement detections and a light sensor for daylight savings. This sensor follows the Zhaga Book 20 mechanical dimensions for a rectangular sensor which suits to a 60 x 22 mm slot on a luminaire. The front side of the sensor is IP65 rated allowing it to be used in applications such as industrial.

A Helvar Freedom connecting cable of a chosen length is required to connect this sensor to a Node. This sensor can be used on the wireless self-learning lighting control solution Helvar ActiveAhead.

If the sensor is connected to non-SELV control gear, the luminaire must be Class I.

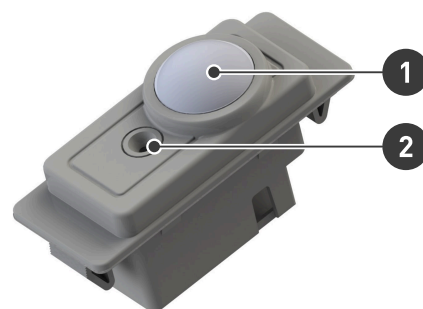

1. PIR sensor
2. Light sensor

Key features

- Small Helvar Freedom luminaire based high bay multisensor for Helvar ActiveAhead®
- Fits to a standard Zhaga Book 20 based rectangular 60 x 22 mm luminaire slot
- IP65 rated front side
- Select a Helvar Freedom connecting cable length of choice

Detection

Detection Coverage

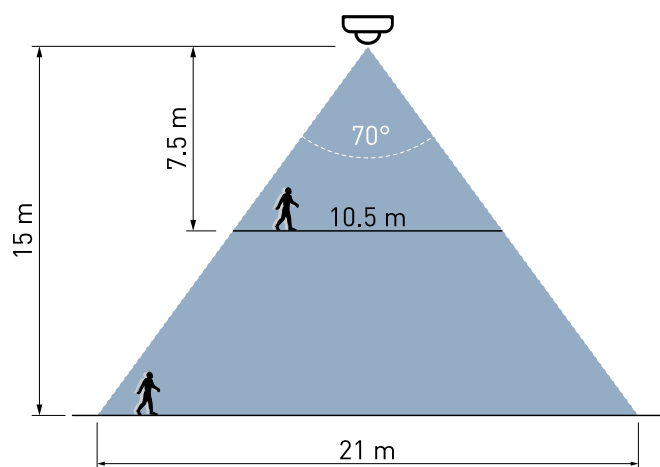

Max recommended mounting height: 17 m

Detection Pattern

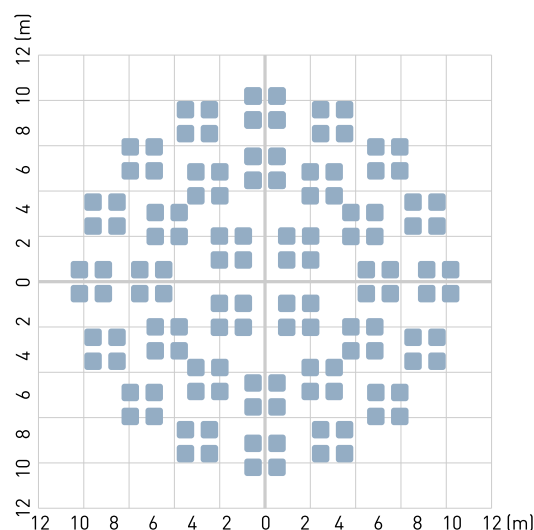

Detection Pattern at floor level for 15 m mounting height

Detection range and sensitivity depends on the speed and size of the moving object as well as its temperature difference to the surroundings. Moving directionally towards the sensor will give worse detection than crossing the detection area on an angle.

Mounting

The Multisense R60 High Bay can be mounted to a luminaire in three ways:

- 1) When mounting from outside in, carefully push the unit into the cutout until it 'clicks' into place and sits flush with the luminaire casing.

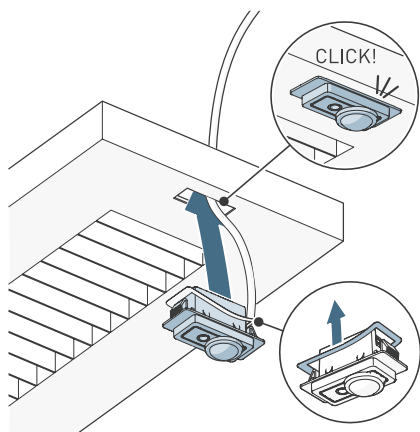

Cutout dimensions (mm)

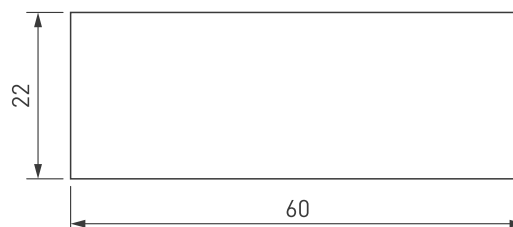

- 2) When mounting from inside out, ensure the face of the unit sits level with the luminaire casing and secure the unit in place. The supported luminaire frame thickness in the range $0.4 \leq d \leq 1.5$ mm.

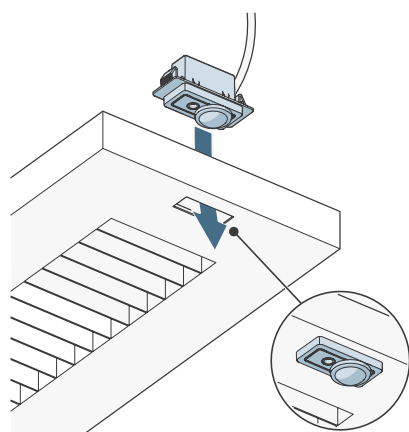

Cutout dimensions (mm)

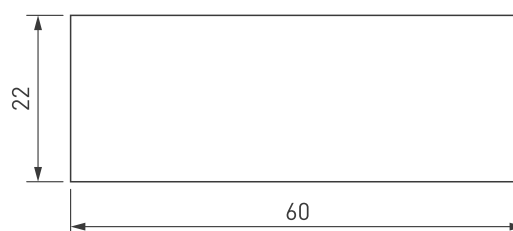

- 3) Using a 5696G - Holder Batten R60 accessory (sold separately).

1. Connect the Freedom connecting cable.

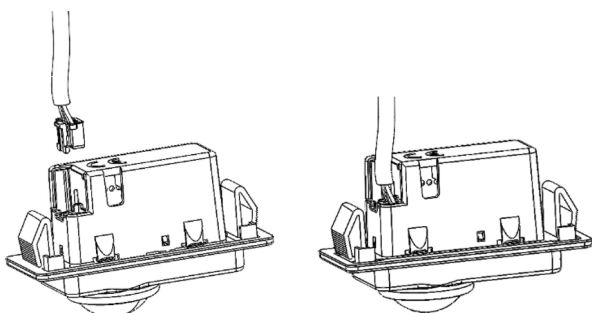

2. Remove the tape liner and feed the cable through the holder. Push the unit into the holder.

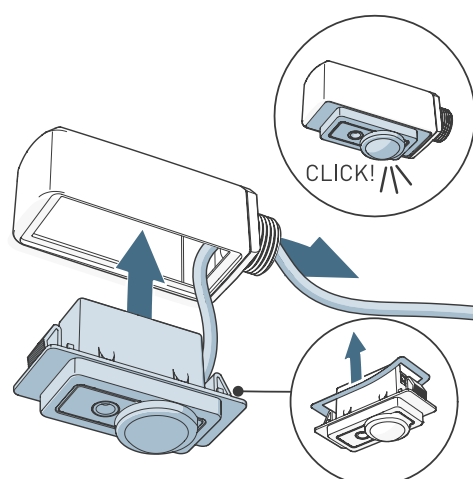

3. Feed the cable through the hole in the luminaire.
Connect the cable to the Node. Fasten the holder to the luminaire using the O-ring and a M20 nut.

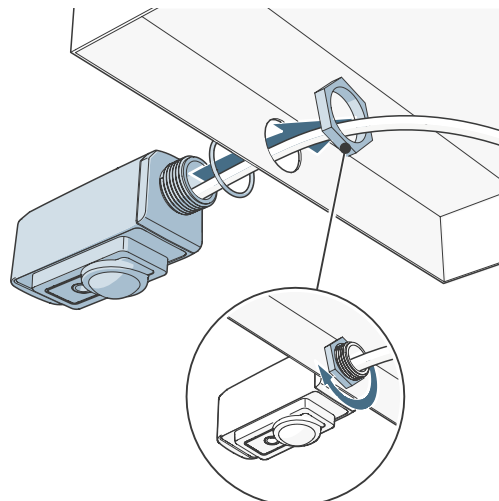

Note: To avoid PIR lens deformation, the PIR lens must be protected from mechanical pressure. Special care must be taken during sensor mounting as well as luminaire transport and installation.

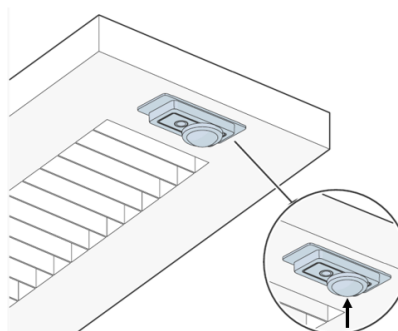

Connections

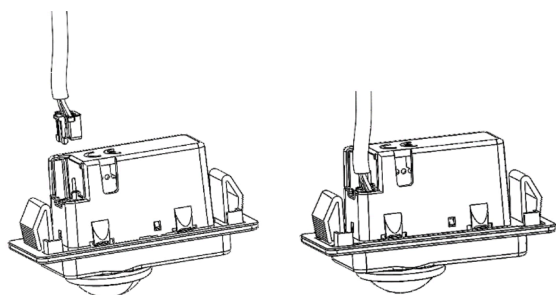

5636 Multisense High Bay has a connector for the Freedom connecting cable.

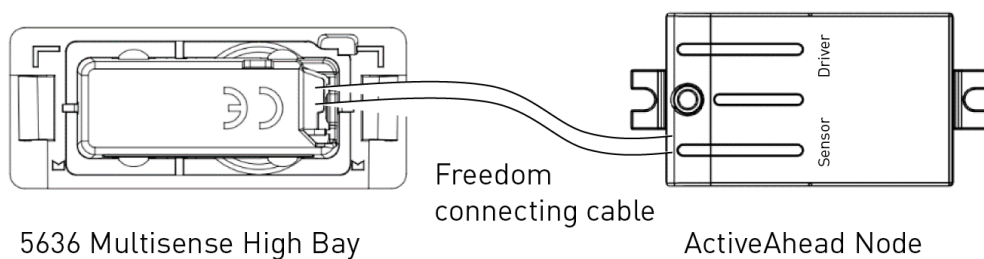

Dimensions (mm)

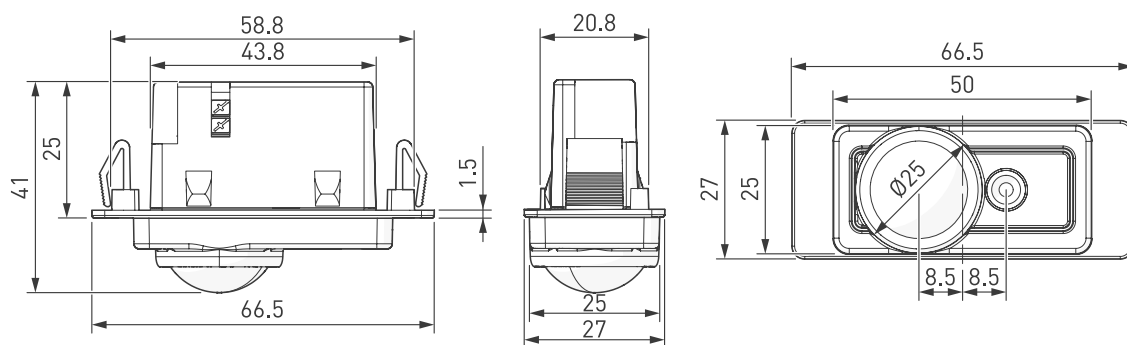

Technical Data

Connections

Freedom:	Connector for the Freedom connecting cable
Note:	If the sensor is connected to non-SELV control gear, the luminaire must be Class I. Cable length must not exceed 150 cm.

Electrical data

Input voltage:	3.3 V
Max. power consumption:	36 mW

Movement detection sensor

Technology:	Passive infrared (PIR) detects moving temperature differences
Detection coverage area:	346 m ² @ 15 m mounting height 87 m ² @ 7 m mounting height achieved with: 8 C° temperature difference to target 1.0 m/s movement speed 700 x 250 mm object size
Max. recommended mounting height:	17 m

Light sensor

Technology:	Closed loop reflected light for bright-out function
Illuminance:	5 lx to 5000 lx

Operating and storage conditions

Ambient temperature:	-20 °C to +50 °C
Note:	The temperature difference between the detection target and the background must be at least 4 °C.
Note:	Frost on lens may block the detection.
Relative humidity:	Max. 85 %, noncondensing
Storage temperature:	-20 °C to +70 °C

Mechanical data

Dimensions:	66.5 x 27 x 41 mm
Material (casing):	Fire-retardant PC/ABS blend
Colour:	Grey (RAL 7035)
IP rating:	IP65 front, IP20 back
Weight:	16 g

Order codes

5636G	Multisense R60 High Bay Grey
Accessories (sold separately)	
5696G	Holder Batten R60 Grey

Conformity and standards

Conformity:	
EMC emission / immunity:	EN 55015 / EN 61547
Safety:	EN 61347-2-11
Environment:	Complies with WEEE, RoHS and REACH directives.